

WORK ORDERED BY: JOHN PAPPAS
C/O DAVID WILLIAMS
P.O. BOX 760
LAKE GENEVA, WISCONSIN 53147

FARRIS, HANSEN & ASSOCIATES, INC.
Engineering, Architecture, Surveying
7 Ridgeway Court P.O. Box 437
ELKHORN, WISCONSIN 53121
Office: (414) 723-2098
Fax: (414) 723-5886

REVISIONS

PROJECT NO.
5318
DATE
07-16-99
SHEET NO.
1 OF 1

PLAT OF SURVEY

PART OF BLOCK 30

ORIGINAL PLAT OF

THE CITY OF LAKE GENEVA

WALWORTH COUNTY, WISCONSIN

SECURITY TITLE COMPANY OF WALWORTH COUNTY

25 N. WISCONSIN STREET, ELKHORN, WI 53121 (414) 723-2929 FAX (414) 723-5251
253 CENTER STREET, LAKE GENEVA, WI 53147 (414) 248-1123 FAX (414) 248-6533

LETTER REPORT: 6422

RE: Angeline Pappas Petros

PARCEL 1:

DESCRIPTION: All that part of Lot No. 1 in Block 30 of the Village of Geneva (Now City of Lake Geneva) in said Walworth County, according to the original plat of said Village of record in the office of the Register of Deeds of said Walworth County described by metes and bounds as follows, to-wit: Commencing at the Northeast corner of said Lot; run thence South in the East line of said Lot 66 feet; run thence West parallel with the North line of said Lot 50 feet; run thence North parallel with the East line of said Lot 66 feet; run thence East in the North line of said Lot 50 feet to the place of beginning.

Certification of Grantee as shown in conveyance recorded in Volume 493 of records on Page 204 as Document No. 197215:

Angeline Pappas Petros

PARCEL 2:

DESCRIPTION: Commencing at a point 66 feet S. of the N. E. corner of Lot No. 1 in Block No. 30, in the City of Lake Geneva, Walworth County, Wisconsin according to the Plat of the Village of Geneva of record; thence W. parallel with the N. line of said Lot 1, 50 feet; thence S. parallel with the E. line of said lot, 44 feet; thence E. parallel with said N. line of said lot, 50 feet to the W. line of Center Street, thence N. in the W. line of Center Street to the place of beginning.

Certification of Grantee as shown in conveyance recorded in Volume 58 of Records on Page 632 as Document No. 642640:

John P. Pappas

PARCEL 3:

DESCRIPTION: Commencing at a point in the W. line of Center Street in the City of Lake Geneva, formerly Village of Geneva, 110 ft. S. of the NE corner of Lot 1 in Block 30 of the original Plat of said Village and City, running thence S. on the W. line of Center Street, 22 ft., thence W. 50 ft., thence N. in a line parallel with the W. line of Center Street, 22 ft., thence E. to the place of beginning.

Certification of Grantee as shown in conveyance recorded in Volume 554 of Records on Page 348 as Document No. 227176:

Peter N. Pappas

PARCEL 4:

DESCRIPTION: Commencing at the Southeast corner of Lot Number One (1), Block Number Thirty (30) of the Village of Geneva, now City of Lake Geneva, Walworth County, Wisconsin, according to the plat of said Village of record in the Office of the Register of Deeds in and for the County of Walworth and State of Wisconsin; run thence West on the line of the Public alley running through said Block, Fifty (50) feet to a Private alley off from the West side of said Block, Forty (40) feet to a Private alley, Forty (40) feet; thence East parallel with the first line of this description, Fifty (50) feet to Center Street in said City; thence South on said Center Street, Forty (40) feet to the place of beginning.

Certification of Grantee as shown in conveyance recorded in Volume 319 of Records on Page 913 as Document No. 100312:

City of Lake Geneva, A municipal Corporation

NOTE: COPIES OF THIS MAP TO WHICH THE FOLLOWING CERTIFICATE WILL APPLY SHOW SURVEYOR'S ORIGINAL SEAL AND SIGNATURE IN RED INK. COPIES BY ANY OTHER MEANS MAY HAVE ALTERATIONS WHICH DO NOT REPRESENT THE SURVEYOR'S WORK PRODUCT.

I HEREBY CERTIFY THAT THE ABOVE DESCRIBED PROPERTY HAS BEEN SURVEYED UNDER MY DIRECTION AND THAT THE ABOVE MAP IS A TRUE REPRESENTATION THEREOF AND SHOWS THE SIZE AND LOCATION OF THE PROPERTY AND ITS EXTERIOR BOUNDARIES. THIS SURVEY IS MADE FOR THE USE OF THE PRESENT OWNERS OF THE PROPERTY, AND ALSO THOSE WHO PURCHASE, MORTGAGE, OR GUARANTEE THE TITLE THERETO WITHIN ONE YEAR FROM THE DATE HEREOF.

DATED: 7-21-99

PETER S. GORDON R.L.S. 2101

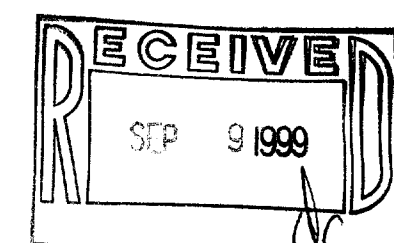

007-1881

MAIN STREET

CENTER STREET

BLOCK 30

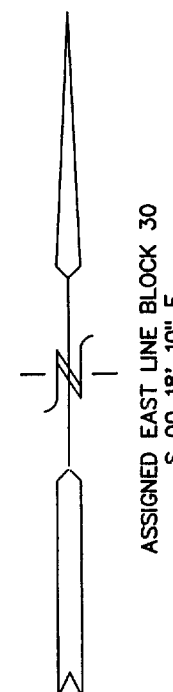
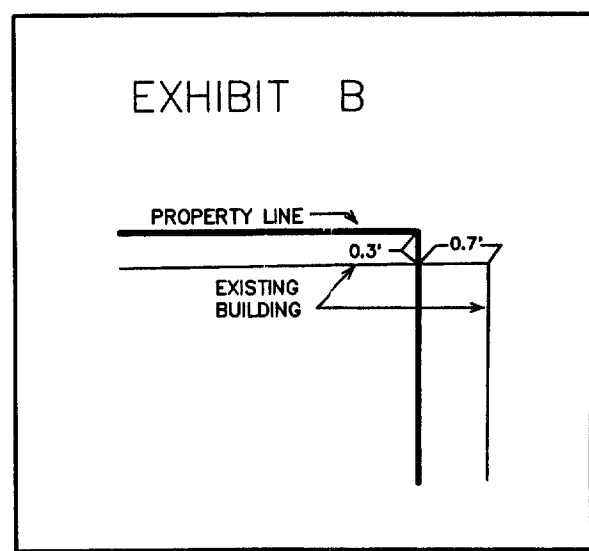
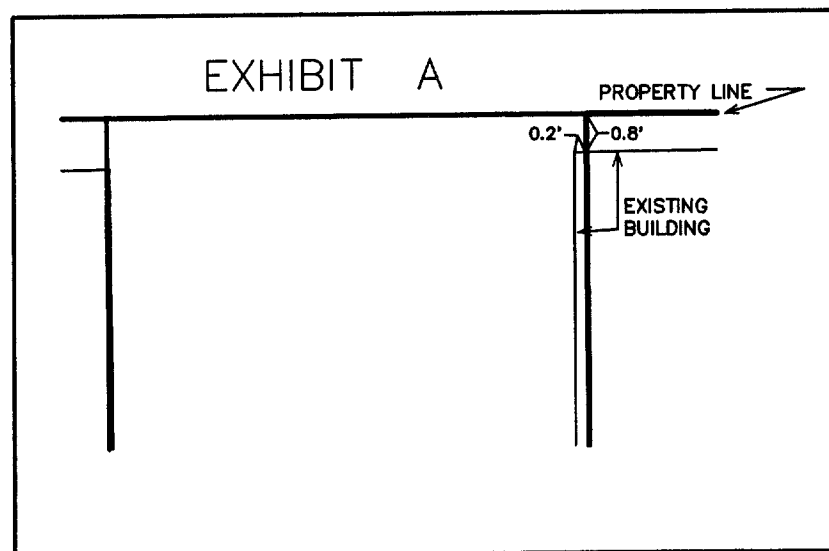

ASSIGNED EAST LINE BLOCK 30
S 00 18' 10" E

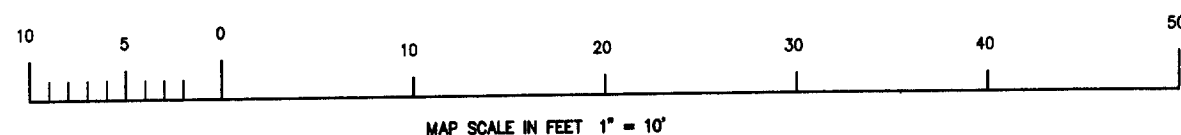

LEGEND

- = FOUND IRON PIPE STAKE
- * = FOUND CHISELED "X"
- = SET CHISELED "X"
- = POWER POLE
- (xxx) = RECORDED AS

MADE IN PAYMENT FOR REBAIL STAKE

16' WIDE ALLEY

OUTLOT 1
CSM 1190

LOT 1 CSM 1190

Jul 21 1999

200-307
200-308
200-309
200-310
2A-1904